



San Diego International Airport Master Plan *Report on Mitigation Measures*

Peninsula Community Planning Board
December 17, 2009

Agenda

- I. Airport Master Plan Projects
- II. Air Quality Management Plan
- III. Regional Aviation Strategic Plan
(RASP)



AMP Implementation Plan

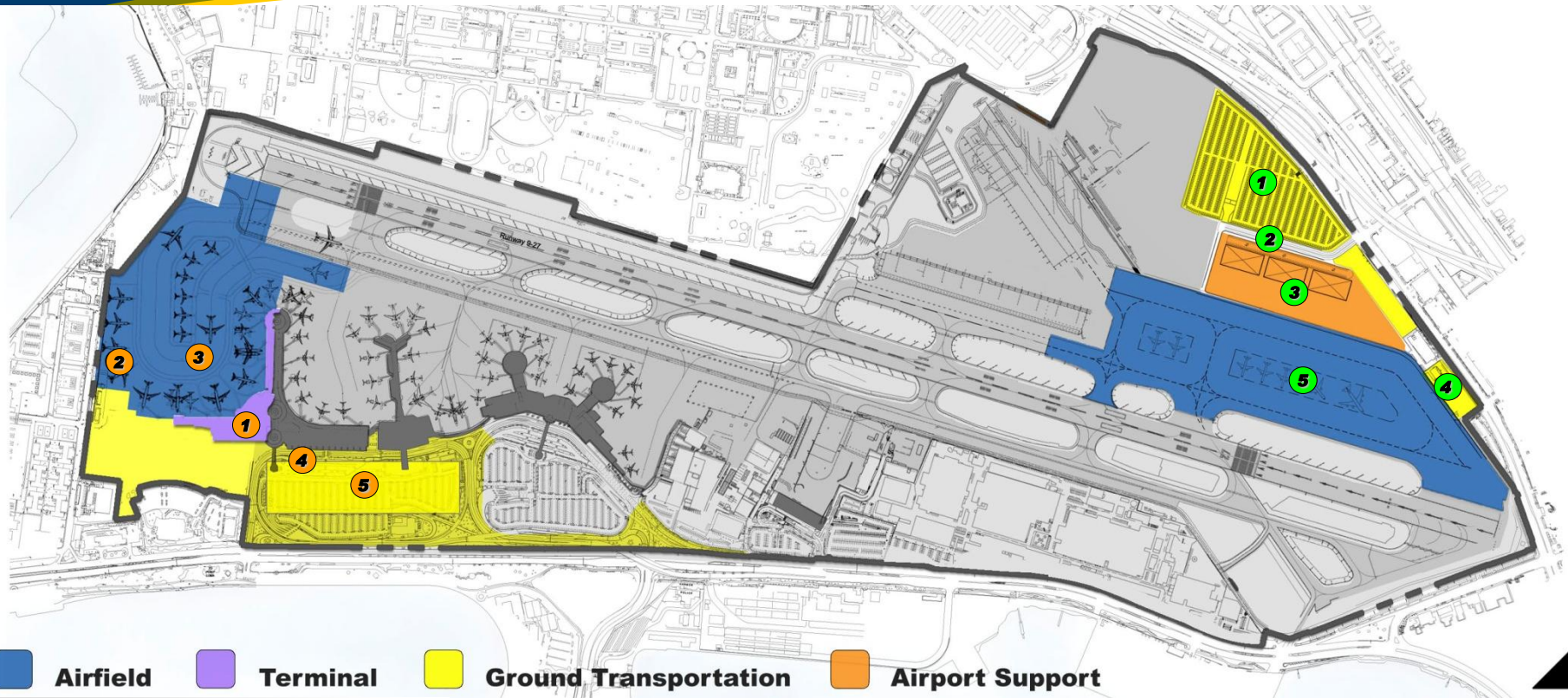

Project Elements

- | | | | |
|---|--|---|--|
| <p>1 Expand existing Terminal 2 West with 10 new jet gates.</p> <p>2 Construct new aircraft parking and replacement Remain-Over-Night (RON) aircraft parking apron.</p> <p>3 Construct new apron and aircraft taxiway.</p> | <p>4 Construct new second level road/curb and vehicle circulation serving Terminal 2.</p> <p>5 Construct a new parking structure and vehicle circulation serving Terminal 2.</p> | <p>1 Relocate and reconfigure SAN Park Pacific Highway.</p> <p>2 Construct a new access road to North Area facilities from Sassafras St./ Pacific Highway intersection.</p> <p>3 Construct new General Aviation facilities including access, terminal/hangars and apron on 12.4 acres.</p> | <p>4 Demolish the existing general aviation facilities.</p> <p>5 Reconstruct Taxiway C, and construct new apron hold pads and new Taxiway east of Taxiway D.</p> |
|---|--|---|--|



Project Implementation

The following projects under construction or program design:

| Taxiway C Rehabilitation | Aug 2009 | July 2010 |
|---|-----------------|------------------|
| Aircraft Apron | 2010 | 2014 |
| Elevated Roadway (at Terminal 2) | 2010 | 2014 |
| Terminal 2 Expansion | 2011 | 2014 |

